



ALISE '13

Always the Beautiful Question:
Inquiry Supporting Teaching,
Research, & Professional Practice
January 22–25, 2013 • Seattle, Washington

ALISE Annual Conference & Exhibition

Official Program

Stop by our booth
to review these and many more
new and bestselling textbooks!

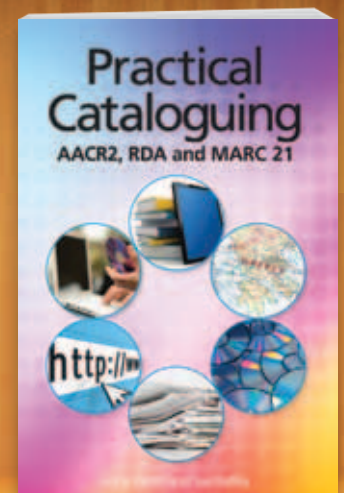
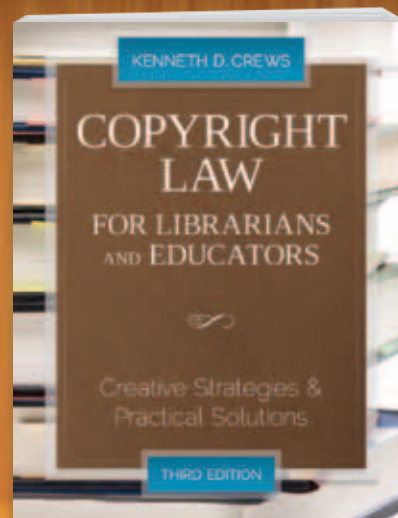
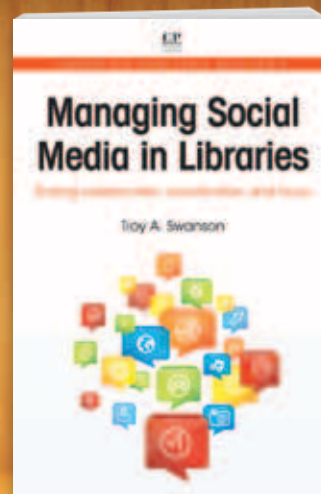
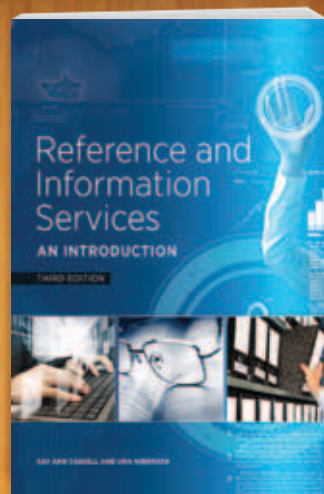
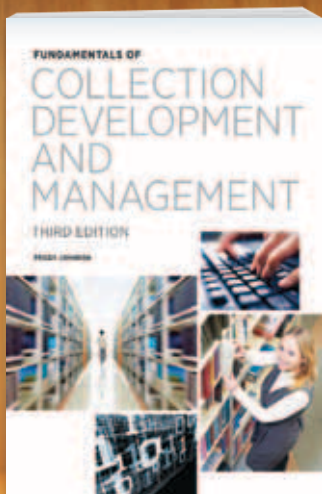

Message from the President



Welcome to the ALISE 2013 conference in Seattle, Washington. This year's theme, "Always the Beautiful Question: Inquiry Supporting Teaching, Research, and Professional Practice," celebrates the desire to know as the heart of teaching and learning, research and scholarship, technical innovation, and professional development. The response from the ALISE membership has been an array of beautiful

questions in the form of panels, papers, posters, programs, and workshops that promise to spark new beautiful questions and further study. I hope that you will enjoy engaging with colleagues, making new friends, and celebrating the accomplishments of ALISE members in the areas of research, teaching, and service. And I also hope that you will join us for a fabulous awards reception at the Seattle Public Library on Thursday evening.

Also to be celebrated is the hard work and contributions of the many hands that are needed to ensure a stimulating annual conference experience. My deepest thanks go to Conference Co-Chairs Don Latham and Heidi Julien who have been indefatigable in their commitment to the conference planning. Many thanks also to the entire Conference Planning Committee (all of whom are amazing), our hard working ALISE committees, and to our vendors and institutional sponsors. I also want to express my appreciation to the ALISE membership for giving me the opportunity to serve the Association in a second term on the Board, to Lynne Howarth, Eileen Abels, and the other members of the ALISE Board of Directors who have been my counsel and my help over the course of this year. Here's to an extraordinary annual meeting. Let us for the length of the conference follow the advice of my favorite poet e. e. cummings, who implores us "never to rest and never to have: only to grow."

Greetings from the ALISE 2013 Conference Co-Chairs



President Melissa Gross posed a conference theme that so fittingly captures our enterprise: *Always the Beautiful Question: Inquiry Supporting Teaching, Research, and Professional Practice*. Indeed, inquiry is what ALISE is all about; it epitomizes our passion, our energies, and our work. Within that broad enterprise, we are a diverse community of scholars and educators. We come together in beautiful Seattle to celebrate that diversity of interest, of method and approach, of focus in our inquiry, to learn from one another, to spark intellectual debate and pursuit, and to welcome new inquirers into our community. We believe that we have crafted a program that will achieve all of those goals.

In addition to offering opportunities for intellectual growth and inquiry, the conference includes many chances for networking and community-building. Conferences should offer a balance of food-for-thought, and social occasions, where we can gather to meet old friends and make new ones. The Works-in-Progress and Doctoral Poster sessions, the Birds-of-a Feather discussions, the evening receptions, and the generous coffee and lunch breaks should provide many chances to meet up with folks. Registrants can meet with like-minded colleagues at the SIG sessions, and explore new ideas in the paper and panel sessions. Acceptance onto this year's program was very competitive, suggesting that the conference will be strong and will offer something for everyone. A special aspect of this year's program is our keynote speaker, Dr. Ann Curry, from the University of Alberta.

Ann is well-known within our field, and she is a scholar with diverse connections, broad intellectual links, and an unusually global perspective. We are delighted that the University of Washington Information School is sponsoring her talk, and we know that her words will challenge all of us.

Thank you to all of you for putting your faith in us to organize an excellent conference, and thank you to our team—John Budd, Jennifer Campbell-Meier, Lenese Colson, Kathleen DeLong, Lisa Given, Tammy Mays, Bharat Mehra, Connie Van Fleet, and ALISE Executive Director Kathleen Combs. You've all been fabulous! We wish everybody a terrific conference and a great visit in Seattle.

RUTGERS

School of Communication
and Information

The Department of Library
and Information Science Welcomes

Ingrid Erickson, MSI, PhD
Sharon Stoerger, MLIS, PhD
and Congratulates



Lilia Pavlovsky, MLIS, PhD
Library Journal 2012 Teaching Award Winner



For information, visit: lis.rutgers.edu

Rutgers, the State University of New Jersey



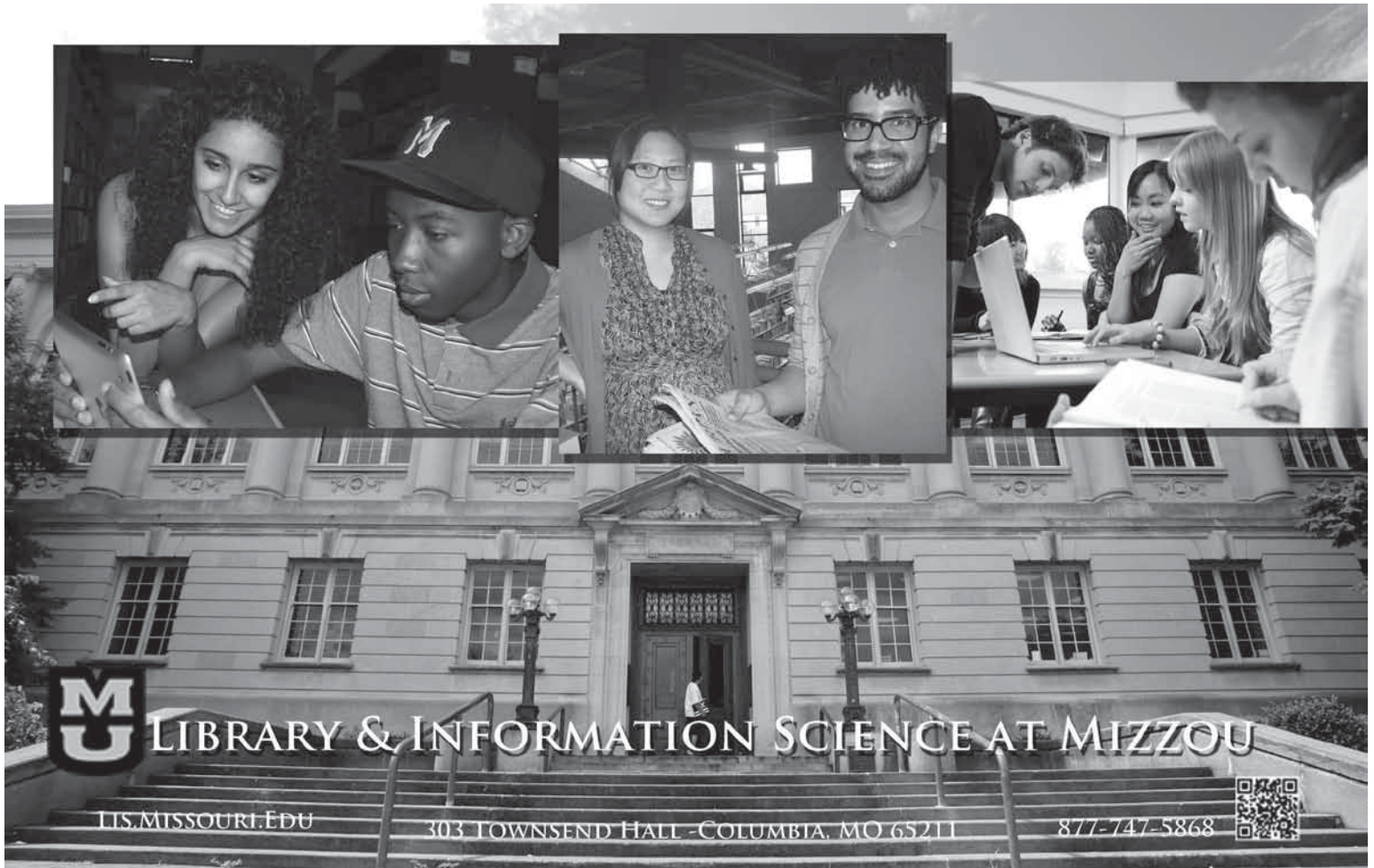

150
YEARS



School of
LIBRARY
AND
INFORMATION
MANAGEMENT

EMPORIA STATE UNIVERSITY

Providing ALA-accredited MLS degrees in a cohort-based, blended instructional format in Emporia and Kansas City, Kansas; Denver, Colorado; Salt Lake City and Orem, Utah; Portland, Oregon; and soon in Atlanta, Georgia.

A cohort-based, blended instruction Ph.D. program is also offered in Kansas City.

<http://slim.emporia.edu>

1-800-552-4770 ■ 1200 Commercial Street ■ Emporia, Kansas 66801

CHANGING LIVES SINCE 1863

ALISE HOSPITALITY SUITE

Join your friends and colleagues for lively discussion, casual networking, and an enjoyable evening

Wednesday, January 23, after the Doctoral Student Research Poster Reception

Thursday, January 24, after the ALISE Awards Reception

Governor Suite, Hyatt at Olive 8 Hotel

ALISE Board of Directors

President: Melissa Gross, Florida State University

Vice President/President-Elect: Eileen Abels, Drexel University

Past President: Lynne Howarth, University of Toronto

Secretary/Treasurer: Steven MacCall, University of Alabama

Director for Membership Services: Ann Carlson Weeks, University of Maryland

Director for Special Interest Groups: Kathleen DeLong, University of Alberta

Director for External Relations: Louise Spiteri, Dalhousie University

Conference Program Planning Committee

Coordinating Chairs: Heidi Julien, University of Alabama; and Don Latham, Florida State University

Chair, ALISE Academy Committee: John M. Budd, University of Missouri-Columbia

Chair, ALISE Jean Tague-Sutcliffe Doctoral Poster Competition Committee: Bharat Mehra, University of Tennessee

Doctoral SIG Conveners: Lenese Colson, Florida State University; and Tammy Mays, University of Wisconsin at Madison

Co-Chairs, Council of Deans, Directors and Program Chairs: Stephen T. Bajjaly, Wayne State University; and Mary Stansbury, University of Denver

Chair, Conference Juried Paper Proposals Committee: Lisa Given, Charles Sturt University

Chair, Conference Panel Proposal Committee: Connie Van Fleet, University of Oklahoma

Director for Special Interest Groups: Kathleen DeLong, University of Alberta

Board Liaison: Melissa Gross, Florida State University

Registration/ Materials

Registration will be open throughout the meeting in the Hyatt at Olive 8 Hotel Ballroom Foyer.

Registration hours:

Tuesday 8:00 a.m. – 6:00 p.m.
Wednesday 8:00 a.m. – 6:00 p.m.
Thursday 8:00 a.m. – 6:00 p.m.
Friday 8:00 a.m. - Noon

NOTE: Attendees must wear name badges for entrance to all conference events, including receptions!

Exhibits

Exhibits are located in the Hyatt at Olive 8 Ballroom Foyer.

Times:

Wednesday 8:00 a.m. to 5:00 p.m.
Thursday 8:00 a.m. to 5:00 p.m.
Friday 8:00 a.m. to 12:00 noon

Cancellation Policy

All cancellations must be submitted in writing and faxed to the ALISE Executive Director at 312-419-8950. Cancellations received before 11:59 p.m. on January 8, 2013, are subject to a \$50 fee. After January 8, 2013, ALISE will give refunds only for documented medical emergencies. Refunds will be processed within 6 weeks after the conference.

Lost and Found

Lost and found checkpoint will be located at the registration desk.

Conference Evaluation

The information that you provide on your conference evaluation will be critical to improvements for future conferences. ALISE will be conducting its evaluation via an online survey. Please watch your email for an invitation to complete the evaluation form online.

Placement Service

Arrangements for interviews should be made directly between candidates and recruiters using the message board in the ALISE Job Placement Center. Please check the board often. When you have made your appointments, check at the registration desk to verify your interview room.

Hyatt at Olive 8 (Main Conference Hotel)

1635 8th Avenue
Seattle, WA 98101
Tel: 206-695-1234
Fax: 206-676-4400

Grant Hyatt (Secondary Conference Hotel and Location of Interviewing Space)

721 Pine Street
Seattle, WA 98101
Tel: 206-774-1234
Fax: 206-774-6120



CONTENTS

- 3 Message from the President and Co-Chairs
- 8 Conference at a Glance
- 10 Daily Calendar
- 26 2013 Award Winners
- 27 Sponsors and Exhibitors
- 27 Raffles
- 28 ALISE Governance
- 29 Maps

CONFERENCE AT A GLANCE

All rooms are in the Hyatt Olive 8 Hotel unless noted

Tuesday	Event	Rooms
8:00 a.m. - 6:00 p.m.	Registration	Ballroom Foyer
8:00 a.m. - 6:00 p.m.	Internet Café	Ballroom Foyer
8:00 a.m. - 8:00 p.m.	Placement Services	Steel A
10:00 a.m. - Noon	WISE Pedagogy Pre-conference Workshop	Ballroom D-E
12:30 p.m. - 4:30 p.m.	ALISE Academy: The Quality behind Qualitative Research	Cobalt
1:00 p.m. - 4:00 p.m.	Curriculum Vitae and Portfolio Review	Cyan A
1:00 p.m. - 4:00 p.m.	ALISE Board of Directors Meeting	Cyan B
4:30 p.m. - 5:30 p.m.	ALISE Leadership Orientation	Azure
5:00 p.m. - 5:30 p.m.	Set-up Works in Progress Poster Session	Ballroom A-E
5:30 p.m. - 6:30 p.m.	ALISE Committee Meetings	Azure
5:30 p.m. - 6:30 p.m.	2013 and 2014 ALISE Conference Program Planning Committee Joint Meeting	Azure
6:30 p.m. - 9:00 p.m.	Opening Reception/Works In Progress Poster Session	Ballroom A-E
Wednesday		
7:00 a.m. - 7:30 a.m.	All Conference Continental Breakfast	Ballroom Foyer
7:30 a.m. - 8:30 a.m.	First Timers' Breakfast	Azure
7:30 a.m. - 8:30 a.m.	SIG Business Meetings: Session 1	Ballroom D-E
8:00 a.m. - 6:00 p.m.	Registration	Ballroom Foyer
8:00 a.m. - 6:00 p.m.	Internet Café	Ballroom Foyer
8:00 a.m. - 5:00 p.m.	Exhibits	Ballroom Foyer
8:00 a.m. - 8:00 p.m.	Placement Services	Steel A
8:30 a.m. - 10:00 a.m.	Session 1: Programs and Papers	
	1.1 ALISE Award Papers 1	Cyan B
	1.2 Juried Papers: Expanding Boundaries	Cyan A
	1.3 "Scaffolding the Walled Garden: Working with Remote Students in Research Apprenticeships"	Cobalt
	1.4 "Surviving the Pre-Tenure Years"	Menzies Suite – Grand Hyatt
	1.5 "International Trends in Library & Information Science Education"	Blewett Suite – Grand Hyatt
10:00 a.m. - 10:30 a.m.	Morning Break	Ballroom Foyer
10:30 a.m. - Noon	Opening Plenary Session: Ann Curry, University of Alberta	Ballroom A-C
12:15 p.m. - 1:45 p.m.	Birds of a Feather	Ballroom D-E
1:00 p.m. - 2:00 p.m.	JELIS Editorial Board Meeting	Washington – Grand Hyatt
2:00 p.m. - 3:30 p.m.	Session 2: Programs and Papers	
	2.1 Juried Papers: Curriculum	Cyan B
	2.2 Juried Papers: Facing Challenges	Cyan A
	2.3 "Exploring ePortfolio as Capstone Experience to Prepare 21 st Century Information Professionals"	Cobalt
	2.4 "Questioning School Librarians: Triangulating Common Core"	Menzies Suite – Grand Hyatt
	2.5 "The AERI Experience: Support, Structure, and Sociality of Inquiry within the Archival Research and Education Field"	Blewett Suite – Grand Hyatt
2:00 p.m. - 4:00 p.m.	ALISE Statistical Report Update	Azure
3:30 p.m. - 4:00 p.m.	Afternoon Break	Ballroom Foyer
3:30 p.m. - 4:00 p.m.	Doctoral Poster Session Setup	Ballroom A-E
3:30 p.m. - 4:00 p.m.	Doctoral Poster Judges Meeting	Cyan A
4:00 p.m. - 5:30 p.m.	Session 3: Programs and Papers	
	3.1 Juried Papers: Professional Identity	Cyan B
	3.2 Juried Papers: Online Education	Cobalt
	3.3 "Inquiry into Education: A Classical Pragmatist Perspective on Learning as Informing"	Azure
	3.4 "Inquiry into the Practice of Advising in LIS"	Menzies Suite – Grand Hyatt
	3.5 "New Directions: Research, Curriculum, and Realignment"	Blewett Suite – Grand Hyatt
4:00 p.m. - 6:30 p.m.	Doctoral Poster Judging	Ballroom A-E
5:45 p.m. - 7:00 p.m.	Past Presidents' Reception – By invitation only	Presidential Suite
7:30 p.m. - 9:00 p.m.	Doctoral Student Research Poster Session and Reception	Ballroom A-E
Thursday		

CONFERENCE AT A GLANCE

7:00 a.m. - 7:30 a.m.	All Conference Continental Breakfast	Ballroom Foyer
7:30 a.m. - 8:30 a.m.	School Representatives' Breakfast	Azure
7:30 a.m. - 8:30 a.m.	SIG Business Meetings: Session 2	Ballroom D-E
8:00 a.m. - 6:00 p.m.	Registration	Ballroom Foyer
8:00 a.m. - 6:00 p.m.	Internet Café	Ballroom Foyer
8:00 a.m. - 5:00 p.m.	Exhibits	Ballroom Foyer
8:00 a.m. - 8:00 p.m.	Placement Services	Steel A
8:30 a.m. - 10:00 a.m.	Session 4: Programs and Papers	
	4.1 ALISE Award Papers 2	Cyan B
	4.2 Juried Papers: Exploring Experiences	Cyan A
	4.3 "Questions Are Never Neutral: Examining the Occupy and Tea Party Movements as Exemplars of Information Research and Everyday (Political) Life"	Cobalt
	4.4 "Where Do We Go from Here? Exploring Perceptions of Community-based Research as 'Serious Research' in Higher Education"	Azure
	4.5 "A Gender-based Inquiry of Health Information Support Services"	Menzies Suite – Grand Hyatt
10:00 a.m. - 10:30 a.m.	Morning Break	Ballroom Foyer
10:30 a.m. - Noon	Session 5: Programs and Papers	
	5.1 Juried Papers: Learning Outside the Classroom	Cyan B
	5.2 Juried Papers: Controversies in LIS Classrooms	Cyan A
	5.3 "Teaching Information Behavior: Sharing Global Experiences"	Cobalt
	5.4 "The Beauty of Subversion: Asking the Difficult Questions in Research, Teaching, and Practice"	Azure
	5.5 "Investigating Online Pedagogical Strategies in Technical Services Education: A Panel Discussion"	Menzies Suite – Grand Hyatt
12:15 p.m. - 2:30 p.m.	Council of Deans, Directors, and Program Chairs Meeting	Ballroom D-E
1:30 p.m. - 3:00 p.m.	Session 6: Programs and Papers	
	6.1 Juried Papers: Collaboration	Cyan B
	6.2 Juried Papers: Innovative Pedagogy	Cyan A
	6.3 "Addressing the Hard Questions on Library Planning, Services, and Evaluation: Collaborative Opportunities for State Library Development Agencies and LIS Programs"	Cobalt
	6.4 "Librarianship Embraces Virtual Media Based on Adult Learning Theory"	Azure
	6.5 "Questioning the Past: Finding, Presenting, and Using the Beautiful Answers of Historical Inquiry"	Menzies Suite – Grand Hyatt
3:00 p.m. - 3:30 p.m.	Afternoon Break	Ballroom Foyer
3:30 p.m. - 4:30 p.m.	ALISE Business Meeting and Kick-off to 2014	Ballroom A-C
4:30 p.m. - 6:00 p.m.	"What of Diversity? (Always the Beautiful and Essential Question): An Ignite Session on Ideas You Can Use To Advance Diversity"	Ballroom D-E
6:30 p.m. - 8:00 p.m.	Awards Reception at Seattle Public Library	Seattle Public Library
Friday		
7:00 a.m. - 7:30 a.m.	All Conference Continental Breakfast	Ballroom Foyer
7:30 a.m. - 8:30 a.m.	SIG Business Meetings: Session 3	Ballroom D-E
8:00 a.m. - Noon	Registration	Ballroom Foyer
8:00 a.m. - Noon	Placement Services	Steel A
8:00 a.m. - Noon	Exhibits	Ballroom Foyer
8:00 a.m. - Noon	Internet Café	Ballroom Foyer
8:30 a.m. - 10:00 a.m.	Session 7: Programs and Papers	
	7.1 OCLC/ALISE Grant Papers	Cobalt
	7.2 Juried Papers: Meta-Perspectives in LIS Research	Azure
	7.3 "New Directions in Archival Education: Teaching Pluralized Curricula"	Ballroom C
	7.4 "Development and Fundraising for IS Programs"	Ballroom B
	7.5 "Beautiful Connections: Questions in Distance Education"	Ballroom A
10:00 a.m. - 10:30 a.m.	Morning Break	Ballroom Foyer
10:30 a.m. - Noon	"How Do You Know That They Know? Devising, Assessing, and Utilizing Program-level Student Learning Outcomes"	Ballroom C
	"Inclusive Gigabit Libraries: Learn, Discuss, and Brainstorm"	Ballroom A
Noon - 3:00 p.m.	ALISE Board of Directors Meeting	Azure
Noon - 2:00 p.m.	Proquest Training Workshop – By invitation only	Ballroom D-E



**Don't let censorship
close the books.**

**FREE
PEOPLE
READ
FREELY**

The Freedom to Read Foundation is the only organization whose main purpose is to defend through the courts the right to access information in libraries. Whether you are a librarian or library supporter, and you value the access libraries provide for everyone in the community, you can't afford not to be a member of the Freedom to Read Foundation.

Join today and start receiving all the benefits of membership, including the quarterly newsletter. Membership starts at \$35 for individuals and \$100 for libraries and other organizations.



**FREEDOM
TO READ
FOUNDATION**
www.ftrf.org

10:00 a.m. - Noon

9th Annual WISE Workshop: Inquiry Across Time and Space Ballroom D-E

Sponsored by the Web-based Information Science Education (WISE) consortium and ALISE Distance Education SIG

This pre-conference workshop is open to all ALISE attendees, whether new to online teaching or experienced. Discussion, demonstration, and other activities to explore theory and practice promoting inquiry and critical thinking in LIS education will be incorporated. The session will encourage participants to consider several facets of online education across a variety of content areas including design, community building, and participatory culture.

Moderator: Rae-Anne Montague, University of Illinois at Urbana-Champaign

Presenters: Nicole Cooke and Karla Lucht, University of Illinois at Urbana-Champaign; and Michael Stephens, San Jose State University

12:30 p.m. - 4:30 p.m.

ALISE Academy: The Quality behind Qualitative Research

Sponsored by H.W. Wilson Foundation

 Cobalt**“What Constitutes Qualitative Research?”**

Discussion Leader: Lisa Given, Charles Sturt University

“What Are the 'Data' for Qualitative Inquiry?”

Discussion Leader: Diane Rasmussen, Western University

“Sophisticated Analysis in a Challenging World”

Discussion Leader: Marie Radford, Rutgers University

Preregistration is required

1:00 p.m. - 4:00 p.m.

Curriculum Vitae and Portfolio Review Cyan A

Polish your professional presentation. Senior faculty will review and critique curricula vitas and portfolios in one-on-one, thirty-minute review sessions. Advanced registered participants will receive preference.

ALISE Board of Directors Meeting Cyan B

4:30 p.m. - 5:30 p.m.

ALISE Leadership Orientation Azure

All members, including all current and incoming ALISE committee chairs and SIG conveners, are invited to attend this meeting to learn more about ALISE.

5:00 p.m. - 5:30 p.m.

Works in Progress Poster Session Set-up Ballroom A-E

5:30 p.m. - 6:30 p.m.

ALISE Committee Meetings Azure**2013 and 2014 ALISE Program Planning Committees Joint Meeting** Azure

6:30 p.m. - 9:00 p.m.

Opening Reception/Works In Progress Poster Session Ballroom A-E

(Hors d'oeuvres and Cash Bar)

The Works in Progress poster session – with posters from faculty, doctoral students, and librarians – presents research in its formative stages and provides an opportunity for presenters and conference attendees to exchange ideas in an informal setting.

7:00 a.m. - 7:30 a.m.

All Conference Continental Breakfast

 Ballroom Foyer

7:30 a.m. - 8:30 a.m.

First Timers' Breakfast

 Azure

Sponsored by The Freedom to Read Foundation

Host: ALISE President-Elect Eileen Abels, Drexel University

Learn about ALISE and how you can get involved.

SIG Business Meetings: Session 1

 Ballroom D-E

Join special interest groups for planning and information discussion.

- Archival/Preservation Education: Mary Edsall Choquette, University of Maryland
- Distance Education: Nora Bird, University of North Carolina at Greenboro
- Gender Issues: Bharat Mehra, University of Tennessee
- Information Ethics: Mirah Dow, Emporia State University
- Research: Pnina Fichman and Howard Rosenbaum, Indiana University
- Technical Services Education: Susan Rathbun-Grubb, University of South Carolina

8:30 a.m. - 10:00 a.m.

Session 1: Programs and Papers

1.1 ALISE Award Papers 1

 Cyan B

Moderator: C. Sean Burns, University of Missouri - Columbia

ALISE Research Grant Competition 2013 Preliminary Report

"Information Vaccine: Using Graphic Novels as an AIDS Information Vaccine for Young Adults"

Presenters: Karen Gavigan and Kendra Albright, University of South Carolina.

ALISE Research Grant Competition 2012 Update

"Teaching in the Age of Facebook and Other Social Media: LIS Faculty and Students 'Friending' and 'Poking' in the Social Sphere"

Presenters: Carolyn Hank, University of Tennessee; Cassidy Sugimoto, Indiana University-Bloomington; and Jeffrey Pomerantz, University of North Carolina at Chapel Hill

ALISE/ProQuest Methodology Paper Competition 2013

"Devising and Implementing a Card-sorting Technique for a Longitudinal Investigation of the Information Behavior of People with Type 2 Diabetes"

Presenter: Beth St. Jean, University of Maryland

ALISE/LMC Paper Award 2013

"Access Denied: School Librarians' Responses to School District Policies on the Use of Social Media Tools"

Presenters: Jeffrey DiScala and Ann Carlson Weeks, University of Maryland

1.2 Juried Papers: Expanding Boundaries

 Cyan A

Moderator: Denice Adkins, University of Missouri - Columbia

"In the Company of Questions: An Introduction to the Invisible Intermediaries of Search"

Search professionals perform invisible intermediation among content providers, search engines, and content consumers. This study compares SEMPO's emerging educational, employment, ethical, and evaluative practices with those of the LIS profession.

Presenter: Betsy Van Der Veer Martens, University of Oklahoma

"Thinking Bigger: It's Really about Information Culture Literacy"

For all the success of academia to promote information literacy, there remain gaps between the practice and the realities of the global information culture. This presentation explores the discrepancy.

Presenter: James W. Marcum, Queens College

"Constructing the Passionate Practitioner to Inspire and Sustain the Profession"

Australian LIS educators have adapted passion-based learning theory to develop learning environments where students acquire skills and connect more deeply with the rich and diverse culture of their new profession.

Presenters: Bernadette Welch and Sue Reynolds, RMIT University; and Mary Carroll, Charles Sturt University

1.3 "Scaffolding the Walled Garden: Working with Remote Students in Research Apprenticeships"

 Cobalt

Convener and Panelist: Anthony Bernier, San Jose State University

How can MLIS students in distributed research apprenticeships contribute to research productivity? Each panelist created research-based activities and will discuss varying degrees of success in meeting project goals. Panelists will discuss these working arrangements and offer helpful methods to ensure student success directed toward research productivity.

Panelists: Jeremy Kemp, and Kristen Radsliff Rebmann, San Jose State University

1.4 “Surviving the Pre-Tenure Years”

 Menzies Suite – Grand Hyatt Hotel

Doctoral Students SIG

Conveners: Lenese Colson, Florida State University; and Tammy Mays, University of Wisconsin at Madison

This SIG panel will provide strategies for surviving the pre-tenure years including suggestions on how to navigate faculty politics and how to thrive in this ever-evolving LIS/iSchool culture.

Panelists: Deborah Charbonneau, Wayne State University; Youngok Choi, Catholic University; and Shari Lee, St. John’s University

1.5 “International Trends in Library and Information Science Education”

 Blewett Suite – Grand Hyatt Hotel

International Library Education SIG

Convener: Rhonda L. Clark, Clarion University

The ALISE International Library Education panel addresses service learning opportunities for LIS students abroad, the role of professional organizations in international school library education, and LIS education in New Zealand and Australia.

Presenters: Heather Lea Moulaison, University of Missouri; Anthony Molaro, Prairie State College; Lesley Farmer, California State University - Long Beach; and Peta Wellstead, Open Polytechnic of New Zealand

10:00 a.m. - 10:30 a.m.

Morning Break

 Ballroom Foyer

10:30 a.m. - Noon

Opening Plenary Session with Ann Curry, University of Alberta

 Ballroom A-C

Sponsored by The University of Washington

Conference Welcome: Don Latham, Florida State University**“Always The Beautiful Answer Who Asks a More Beautiful Question”: e. e. cummings and LIS Education”****Introduction of Keynote Speaker: Heidi Julien, University of Alabama**

Ann will discuss what the prose and poetry of e.e. cummings have to tell us about the value of disrupting the medium and the message to better meet library/information science needs, the crucial importance of our inspiring creative (and sometimes unsettling) “beautiful questions” to be asked within our classes, and the need for us to foster individual opinion in students held ever more tightly within Mill’s “tyranny of the majority”.

Ann has alternated careers as a librarian and a professor in Canada, Malaysia, Australia, and England since graduating as a librarian in 1972, and subsequently obtaining her PhD in Information Studies from Sheffield in 1993. She has worked as a business librarian and a children’s

puppeteer, and managed an oil company library, school library, and a public library. She has chaired and taught within library and information science education programs at Grant MacEwan University; The University of British Columbia, where she is professor emerita; and the University of Alberta, where she now teaches in the Graduate Program in Communications and Technology. Ann has won both a Canadian Killam prize and the ALISE award for her teaching. She is committed to strengthening academic/community relationships, and to that end is a frequent speaker at community events and library professional development conferences. Her research and teaching interests focus on access to information issues, especially those associated with controversial subjects and those that involve inequitable access for particular groups; qualitative research methods; library architecture; and library history.

Ann Curry, Ph.D., Professor, Graduate Program in Communication & Technology, Faculty of Extension, University of Alberta

12:15 p.m. - 1:45 p.m.

Birds of a Feather

 Ballroom D-E

Organizer: Stephen T. Bajjaly, Wayne State University

Meet fellow conferees who share your teaching subject interests for informal, roundtable discussion about course content, teaching techniques, learning activities, and best practices. Attend looking for advice or offering knowledge and experiences. Discover contacts for the rest of the conference and beyond. Feel free to bring a brown bag lunch if you wish. Lunch options will be available for purchase at this session.

- Administration and Management: Deborah Turner, Drexel University
- Archives/Special Collections: Mary Edsall Choquette, University of Maryland
- Cataloging, Classification and Metadata: Gretchen Hoffman, Texas Women’s University
- Competitive Intelligence / Data Analytics: Lisa O’Connor, University of Kentucky
- Digital Content Management: Nora Bird, University of North Carolina at Greensboro
- Distance Learning: Stephen T. Bajjaly, Wayne State University
- Ethics: Jean Preer, Indiana University - Indianapolis
- Field Experiences: Internships, Practica, Etc.: Susan Searing, University of Illinois at Urbana-Champaign
- Health Informatics and E-Science: Deborah Charbonneau, Wayne State University
- Information Literacy Instruction: Heidi Julien, University of Alabama
- Learning Outcomes Assessment: Susan Rathbun-Grubb, University of South Carolina
- Reference and Information Services: Lily Rozaklis, Drexel University
- Research Methods: Lisa Given, Charles Sturt University
- Social Networking/Web 2.0: Suellen Adams, University of Rhode Island
- Youth Services: Carolyn Brodie, Kent State University

1:00 p.m. - 2:00 p.m.

JELIS Editorial Board Meeting

 Washington – Grand Hyatt Hotel

2:00 p.m. - 3:30 p.m.

Session 2: Programs and Papers

2.1 Juried Papers: Curriculum

 Cyan B

Moderator: John Budd, University of Missouri - Columbia

"An Outcome-based Assessment of a New eScience Librarianship Curriculum: The Scientific, Technical, and Social Aspects"

Student assessment was the culmination of a 3-year program to demonstrate a new eScience Librarianship curriculum. Survey response analysis will assess whether the new specialization enhanced students' technical facility to appropriately manage research data.

Presenters: John D'Ignazio and Jian Qin, Syracuse University

"Curriculum Mapping in LIS: Assuring Professional Standards Compliance"

Presents a curriculum mapping method to ensure, document and demonstrate how curriculum incorporates coherent courses of study that systematically address required MLS learning outcomes.

Presenters: Mirah J. Dow and Andrew J.M. Smith, Emporia State University

"Innovation, Competition, and Continuity: Library and Information Science Education in Japan"

Education in Japan is usually said to parallel education in North America. This paper will examine how this applies regarding LIS in order for innovations and divergences.

Presenter: Andrew B. Wertheimer, University of Hawaii

2.2 Juried Papers: Facing Challenges

 Cyan A

Moderator: Lisa Hussey, Simmons College

"A Question of Survival? Strategies for the Small LIS School"

How can small library and information studies programmes survive in changing times? This case study examines ways in which Victoria University of Wellington's Information Studies has responded to various threats.

Presenters: Brenda Chawner and Gillian Oliver, Victoria University of Wellington

"Social Marketing: An Impact Strategy for Libraries and Information Centers in Times of Change and Crisis"

Social marketing employs marketing principles and strategies aimed at improving society. This study explores and analyzes social marketing research conducted by the authors in three different types of library environments.

Presenters: Barbara F. Immroth and Bill Lukenbill, University of Texas at Austin

"Similar Challenges, Similar Approaches? A Comparison of Canadian LIS and Journalism Education Programs"

LIS and journalism are closely related fields experiencing similar challenges including outsourcing. Instructors in both fields were interviewed to see how education programs were responding to these challenges.

Presenters: Heather Hill and Meredith Levine, Western University

2.3 "Exploring ePortfolio as Capstone Experience to Prepare 21st Century Information Professionals"

 Cobalt

Convener and Panelist: Peiling Wang, University of Tennessee

Please come to interact with the panelists on the need for evidence-based learning to transform LIS education, the challenges and opportunities to adopt eportfolios in LIS Master's programs as capstone experiences and program outcomes assessments.

Panelists: Cecelia Brown and Betsy Van der Veer Martens, University of Oklahoma; Ed Cortez, University of Tennessee; and Sandra Hirsh, San Jose State University

2.4 "Questioning School Librarians: Triangulating Common Core"

 Menzies Suite – Grand Hyatt Hotel

School Library Media SIG

Convener: Lesley Farmer, California State University - Long Beach; and Mirah Dow, Emporia State University

What factors impact school librarian collaboration? What inputs contribute to effective school libraries? What is the future of school librarian education? Three research studies ask – and answer --these timely questions using the Common Core standards "lens" in this panel session.

Presenters: Mega M. Subramaniam, Ann Edwards, Minjung Ryu, and Rebecca Oxley, University of Maryland; Ross Todd, Rutgers University; and Gail Dickinson, Sue Kimmel, and Carol Doll, Old Dominion University

2.5 "The AERI Experience: Support, Structure, and Sociality of Inquiry within the Archival Research and Education Field"

 Blewett Suite – Grand Hyatt Hotel

Archival/Preservation Education SIG

Convener and Presenter: Mary Edsall Choquette, University of Maryland

The Archival Education Research Institute (AERI) provides a dynamic venue for archival researchers and teachers to interact in an intensive, collegial collaborative environment. Funded by IMLS, the Institute just completed its fourth year. This panel will present the experience of five attendees at varying stages of their careers, and will explore the role of the inquiry in building professional identities and relationships within and beyond the institute environment.

Presenters: Sarah Ramdeen, University of North Carolina at Chapel Hill; Kenneth Lavender, Syracuse University; and Lorraine Richards and Heather Willever-Farr, Drexel University

2:00 p.m. - 4:00 p.m.

ALISE Statistical Report Update

 Azure

Danny P. Wallace, University of Alabama; and ALISE Board of Directors

3:30 p.m. - 4:00 p.m.

Afternoon Break

 Ballroom Foyer

3:30 p.m. - 4:00 p.m.

Doctoral Poster Session Setup

 Ballroom A-E

Doctoral Poster Judges Meeting

 Cyan A

4:00 p.m. - 5:30 p.m.

Session 3: Programs and Papers

3.1 Juried Papers: Professional Identity

 Cyan B

Moderator: Grant Campbell, Western University

“I am a... How Do Future LIS Professionals Identify Themselves?”

In LIS environments, there are a variety of identifications and titles, even for positions with similar expectations and responsibilities. What influences how the individual shapes a professional identity in an LIS program?

Presenters: Lisa Hussey, Simmons College; and Jennifer Campbell-Meier, University of Alabama

“Pop Culture and the Socialization of LIS Students”

In this presentation, we will look at the pop culture images relevant to LIS students in their education and their choice of career.

Presenters: Lisa Hussey and Mary Wilkins Jordan, Simmons College

“ ‘I felt like a real librarian’: Field Experiences as an Opportunity for Professional Identity Development”

Librarians’ professional identity is rarely addressed in LIS literature. Examining the roles of co-op placements in the formation of professional identity, this research explores issues associated with LIS education and field experiences.

Presenters: Selinda Berg, University of Windsor; and Kristin Hoffmann, Western University

3.2 Juried Papers: Online Education

 Cobalt

Moderator: Don Latham, Florida State University

“Online Student Experiences: Inquiry Supporting LIS Education”

A national survey was conducted to learn about the online MLIS student population, their preferences and their experiences. The inquiry supports LIS programs and faculty offering and considering online education.

Presenters: Fatih Oguz, Anthony Chow, Clara Chu and Mimi Smith-Decoster, University of North Carolina at Greensboro

“Who Do You Know? A Study of Connectedness in Online Education and Employment”

An exploratory study investigated the role of social ties for employment prospects. Findings suggest important differences depending upon the percentage of online classes taken during matriculation.

Presenters: Fatih Oguz and Nancy Poole, University of North Carolina at Greensboro

“A Cross-institutional Examination of Modality Delivery Preference for Online Course Delivery” [Featured Presentation]

A focus group with students cross-enrolled in two programs examined mode preference of online courses. Impact factors include teaching style, instructional design, and topicality. Findings address modality and instructional style.

Presenters: Laurie Bonnici, M. Katherine Klose, and Heidi Julien, University of Alabama; and Stephanie Maatta and Stephen T. Bajjalay, Wayne State University

3.3 “Inquiry into Education: A Classical Pragmatist Perspective on Learning as Informing”

 Azure

Moderator and Panelist: Heather Hill, Western University

In this panel, we question the process of learning, informing, and the role of truth in achieving knowledge. We introduce classical pragmatism as a useful method to guide actions aimed towards learning. We will engage with the audience to determine how this approach pertains to LIS education.

Panelists: Jen Pecoskie, Wayne State University; and John M. Budd, University of Missouri-Columbia

3.4 “Inquiry into the Practice of Advising in LIS”

 Menzies Suite – Grand Hyatt Hotel

New Faculty SIG

Conveners: Heather Lea Moulaison and Jenny Bossaller, University of Missouri

This interactive, participatory panel session will clarify the purposes of, and best practices for, advising and mentoring in LIS programs, focusing on the standpoint of advisor/mentor.

Panelists: Denice Adkins, University of Missouri-Columbia; Terry L. Weech, University of Illinois at Urbana-Champaign; and Katherine M. Wisser, Simmons College

3.5 “New Directions: Research, Curriculum, and Realignment”

 Blewett Suite – Grand Hyatt Hotel

Research SIG

Conveners and Panelists: Pnina Fichman and Howard Rosenbaum, Indiana University-Bloomington

New directions in professional practice and research shape innovations in LIS curricula. Panelists will discuss ways that research synergies in data science and curation drive reorganizations across the LIS landscape

Panelists: Corinne Jorgensen, Florida State University; Jeonghyun (Annie) Kim, University of North Texas; Stacy Kowalczyk, Dominican University; Debora Shaw, Indiana University-Bloomington; and Helen R. Tibbo, University of North Carolina at Chapel Hill

4:00 p.m. - 6:30 p.m.

Doctoral Poster Judging

 Ballroom A-E

5:45 p.m. - 7:00 p.m.

Past Presidents’ Reception - by invitation only

 Presidential Suite

7:30 p.m. - 9:00 p.m.

Doctoral Student Research Poster Session and Reception

 Ballroom A-E
(Hors d’oeuvres and Cash Bar)



Innovations in **Library and Information Science**

Congratulations to Dominican’s First PhDs!

- **Elizabeth P. Garcia**—Information Seeking Behaviors of the School Social Worker: What Is the Librarian’s Role in the Practice of Bibliotherapy?
- **Anthony Molaro**—Merging Large and Complex Library Organizations: A Phenomenological Approach to the Lived Experiences of Those Directly Involved
- **Amy Phillips-Haskett**—Framing the Public Library: The Public Perception of the Public Library in the Media
- **Christina Ward**—Fiction in the Young Adult Drug Curriculum: Impacts and Impressions

To find out more about Dominican’s doctoral program in library and information science, including how to apply, visit our website at gslis.dom.edu/academics/phd



DOMINICAN UNIVERSITY
Graduate School of Library & Information Science

dom.edu/gslis | 708.524.6845

7:00 a.m. - 7:30 a.m.

All Conference Continental Breakfast

📌 Ballroom Foyer

7:30 a.m. - 8:30 a.m.

School Representatives' Breakfast

📌 Azure

Sponsored by The University of Alabama

SIG Business Meetings: Session 2

📌 Ballroom D-E

Join special interest groups for planning and informal discussion

- Curriculum: YoaJin Ha, Clarion University
- Development & Fundraising: Edward Cortez, University of Tennessee
- Information Policy: Nicole Alemanne, Florida State University
- International Library Education: Rhonda L. Clark, Clarion University
- Multicultural, Ethnic, and Humanistic Concerns: Nicole Cooke, Rutgers University; and Delicia Greene, Syracuse University
- New Faculty: Jenny Bossaller and Heather Moulaison, University of Missouri – Columbia
- School Library Media: Lesley Farmer, California State University – Long Beach, and Mirah Dow, Emporia State University

8:30 a.m. - 10:00 a.m.

Session 4: Programs and Papers**4.1 ALISE Award Papers 2**

📌 Cyan B

Moderator: Linda Most, Valdosta State University

ALISE/Eugene Garfield Doctoral Dissertation Competition 2013**"Appraisal Learning Networks: How University Archivists Learn to Appraise through Social Interaction"**

Presenter: Kimberly Anderson, University of California – Los Angeles

"Archiving the Unspeakable: Silence and Voice in Khmer Rouge Mug Shots"

Presenter: Michelle Caswell, University of Wisconsin at Madison

ALISE/Bohdan S. Wynar Research Paper 2013:**"Not Dead Yet! A Longitudinal Study of Query Type and Ready Reference Accuracy in Live Chat and IM Reference"**

Presenters: Marie Radford, Rutgers University, and Lynn Silipigni Connaway, OCLC

"The Strange Case of Eugenics: A Subject's Ontogeny in a Long-lived Classification Scheme and the Question of Collective Integrity"

Presenter: Joseph Tennis, University of Washington

4.2 Juried Papers: Exploring Experiences

📌 Cyan A

Moderator: Heather Hill, Western University

"'Pass on what you have learned, Luke': Exploring Experiences of Research Assistantship"

Little literature speaks to the research assistant (RA) experience, despite their importance in the research process. Using autoethnography, this paper explores research, teaching, and mentorship processes of the RA/supervisor relationship.

Presenters: Caroline Whippey and Diane Rasmussen, Western University; and Nadine Desrochers, University of Montréal

"Through the Eyes of Students: An Inquiry into Undergraduates' Research Skills and Practices"

This paper reports results of a study of undergraduates' research skills and practices as they transition from high school into the post-secondary environment. PhotoVoice methodology was used to gather data to inform LIS pedagogy and Information Literacy instruction.

Presenters: Anne Carr-Wiggin, University of Alberta and Darel Bennedbaek, Canadian University College

"Asking the Beautiful Questions about School District Library Supervisors: An Initial Inquiry into the Roles, Responsibilities, and Challenges Faced by Individuals Responsible for Library Programs at the District Level"

The authors will present preliminary survey data about the roles, responsibilities, challenges, education, experience, and demographics of school district library supervisors from across the country. This is the first study of its kind since the 1960s.

Presenters: Jeffrey DiScala and Ann Carlson Weeks, University of Maryland

4.3 "Questions Are Never Neutral: Examining the Occupy and Tea Party Movements as Exemplars of Information Research and Everyday (Political) Life" [Featured Presentation]

📌 Cobalt

Convener: Jessa Lingel, Rutgers University

This panel discusses the Tea Party and Occupy Movements as examples of information as deeply political. We present issues of method, practice and education in terms of personal, informational politics.

Panelists: Jessa Lingel, Rutgers University; Gary Burnett and Julia Skinner, Florida State University; and John M. Budd, University of Missouri-Columbia

4.4 "Where Do We Go from Here? Exploring Perceptions of Community-based Research as 'Serious Research' in LIS Education"

📌 Azure

Multicultural, Ethnic and Humanistic Concerns SIG

Conveners: Nicole A. Cooke, University of Illinois at Urbana-Champaign, and Delicia T. Greene, Syracuse University

Scholars conducting community-based research will discuss how they navigate professionally in academic environments. Panelists will discuss the benefits of “research in practice” and discuss ways to create inclusive academic environments.

Panelists: Tonyia Tidline, Dominican University; Delicia T. Greene, Syracuse University; and Beth Patin, University of Washington

4.5 “A Gender-based Inquiry of Health Information Support Services”

 Menzies Suite – Grand Hyatt Hotel

Gender Issues SIG

Convener and Panelist: Bharat Mehra, University of Tennessee

Four panelists present gender-based perspectives and issues regarding how health information support services in the United States and abroad are represented in LIS teaching, research, and service delivery.

Panelist: Lesley Farmer, California State University - Long Beach; Tom Adamich, Mitinet Library Services; and Peta Wellstead, Open Polytechnic of New Zealand

10:00 a.m. - 10:30 a.m.

Morning Break

 Ballroom Foyer

10:30 a.m. - Noon

Session 5: Programs and Papers

5.1 Juried Papers: Learning Outside the Classroom

 Cyan B

Moderator: France Bouthillier, McGill University

“Becoming a Professional: A Case for Community Service Learning in LIS Education”

A study of the learning process of LIS students engaged in a volunteer community service learning program was conducted using “shift notes” – a structured diary-like instrument for data collection. The study captures aspects of socialization and the process of becoming professionals that are such essential, but challenging, aspects of LIS education.

Presenters: Leanna Jantzi, Capilano University; Heather O’Brien and Luanne Freund, University of British Columbia; and Samantha Sinanan, Douglas College

“Questioning the LIS Internship: Who Is the Learner?”

The beautiful question raised in this presentation is about what happens for both the practitioner supervisor and the LIS educator during an internship experience. What do all participants learn?

Presenters: Nora J. Bird and Michael Crumpton, University of North Carolina at Greensboro

“The International Question: Experiential Learning Overseas as an Integral Component of Library Science Education”

Describes international learning opportunities in the ESU MLS program, from service learning through experiential learning to the professional exchange model, and discusses the impact on student learning and program achievement.

Presenters: Andrew J.M. Smith and Gwen Alexander, Emporia State University

5.2 Juried Papers: Controversies in LIS Classrooms

 Cyan A

Moderator: Eric Meyers, University of British Columbia

“Too Taboo? Examining Sex in LIS Education Texts”

LIS education texts were examined for treatment of sexually explicit topics. Findings show a generally pejorative or simplistic treatment of complex, socially constructed concepts like ‘pornography’ and ‘erotica.’

Presenters: Heather Hill and Marni Harrington, Western University

“How Do (or Should) We Prepare the Next Generation of Faculty in LIS and iSchools?”

This paper considers a doctoral seminar, “Academic Culture and Practice,” taught at Pittsburgh, as a means of raising significant issues relating to how we prepare the next generation of faculty.

Presenter: Richard Cox, University of Pittsburgh

“Employable Skills and Ethical Concerns in LIS Education: The Case of FRBR and Shakespeare”

This paper uses the FRBR cataloguing conceptual model to explore the overlap between skills acquisition and intellectual inquiry in LIS education, showing how broader intellectual questions such as censorship manifest themselves at the level of specific procedures, systems, and skills.

Presenter: D. Grant Campbell, Western University

5.3 “Teaching Information Behavior: Sharing Global Experiences”

 Cobalt

Convener and Panelist: Dania Bilal, University of Tennessee

Generally speaking, the focus of information behavior research has been on users, theories, and models. Teaching information behavior deserves more attention especially as new digital media and emerging technologies are impacting on user information behavior. New challenges and opportunities are faced by information behavior researchers in understanding how users of social network systems seek, collaborate, share, create, use and manage information. Presenters at this panel will share their national and international experiences on teaching information behavior. They will also discuss new research methods designed to capture user information behavior in new digital media.

Panelists: Sanda Erdelez, University of Missouri-Columbia; Karen Fisher, University of Washington; and Peiling Wang, University of Tennessee

5.4 “The Beauty of Subversion: Asking the Difficult Questions in Youth Research, Teaching, and Practice”

 Azure

Youth Services SIG

Conveners: Anna L. Nielsen, Boston College, and Sarah Park Dahlen, St. Catherine University

This panel aims to subvert beauty beyond aesthetics to scholastic action in youth services, particularly into areas that are difficult and controversial, or at least difficult to openly discuss.

Panelists: Don Latham and Jonathan M. Hollister, Florida State University; Jamie Campbell Naidoo, University of Alabama; Sue Kimmel, Danielle Forest, and Kasey Garrison, Old Dominion University; Mega Subramaniam, University of Maryland; Kyungwon Koh, University of Oklahoma, and Karen Gavigan, University of South Carolina

5.5 “Investigating Online Pedagogical Strategies in Technical Services Education: A Panel Discussion”

 Menzies Suite – Grand Hyatt Hotel

Technical Services Education SIG

Convener and Panelist: Susan Rathbun-Grubb, University of South Carolina

This panel discussion brings together LIS faculty members to discuss their investigative approaches to developing sound pedagogical practices in the online technical services classroom. The panelists will share best practices as well as “pitfalls” to avoid, along with examples of activities, assignments and assessment tools that attendees can use.

Panelists: Gretchen Hoffman, Texas Woman’s University; Douglas King, University of South Carolina; Heather Lea Moulaison, University of Missouri-Columbia; and Karen Snow, Dominican University

12:15 p.m. - 2:30 p.m.

Council of Deans, Directors, and Program Chairs Meeting

 Ballroom D-E

Join fellow Deans, Directors, and Program Chairs for a Dutch Treat lunch and discussion of issues important to LIS program administrators.

Chairs: Stephen T. Bajjaly, Wayne State University, and Mary Stansbury, University of Denver

1:30 p.m. - 3:00 p.m.

Session 6: Programs and Papers

6.1 Juried Papers: Collaboration

 Cyan B

Moderator: Kathleen DeLong, University of Alberta

“Communication and Dialogue: Understanding Success in the Collaboration between the Classroom and the Centro para Puerto Rico (CPP)”

This paper explores the communicative lessons of collaboration between a core class at the University of Puerto Rico (Rio Piedras Campus) Library School and the Centro Para Puerto Rico (CPP).

Presenters: Sergio Chaparro-Univazo, Eliut D. Flores, and Carlos Suárez Balseiro, University of Puerto Rico

“Broadening the Field of Inquiry: How and Why LIS Faculty Collaborate”

Survey results (n=141) suggest that LIS faculty are active collaborators, although serious inhibitors and barriers, such as perceived lack of contribution from others and conflicting personalities, are also present.

Presenters: Lisl Zach and Prudence W. Dalrymple, Drexel University

“Community Informatics Studio: Designing Experiential Learning to Support Teaching, Research, and Practice” [Featured Presentation]

This paper introduces a model of experiential learning to support LIS teaching, research, and practice. “Community Informatics Studio” uses studio-based learning to support enculturation into the field of community informatics.

Presenters: Martin Wolske and Colin Rhinesmith, University of Illinois at Urbana-Champaign

6.2 Juried Papers: Innovative Pedagogy

 Cyan A

Moderator: Bernadette Welch, RMIT University

“Communities of Practice: An Effective Environment for Authentic Inquiry”

By addressing typical gaps in learning environments, a communities of practice approach effectively fosters new ways of seeing the problems that arise in research and professional practice – the foundation for asking beautiful questions.

Presenter: Joyce Yukawa, St. Catherine University

“Teaching with Case-Based Instruction”

This presentation describes the implementation of case-based instruction in an online discussion forum. Findings indicate that using case-based instruction increases students’ understanding of issues and practice of accepted standards of professional behavior.

Presenter: Jeonghyun (Annie) Kim, University of North Texas

“Putting a Human Face on Library Services: A Framework for Persona-Centred Design” [Featured Presentation]

This paper proposes a unique user analysis and service development framework for LIS pedagogy based in the Personas design technique, illustrated with examples from a Young Adult Services curriculum.

Presenter: Eric Meyers, University of British Columbia

6.3 “Addressing the Hard Questions on Library Planning, Services, and Evaluation: Collaborative Opportunities for State Library Development Agencies and LIS Programs”

 Cobalt

Convener and Panelist: Elizabeth Aversa, University of Alabama
State library agencies and LIS education programs share interests in

library planning, evaluation and services. This panel presentation explores how these distinct entities can collaborate to answer shared questions.

Panelists: John Carlo Bertot, University of Maryland; Jennifer Campbell-Meier, University of Alabama; Trudi Bellardo Hahn, Drexel University; and Rebecca Mitchell, Alabama Public Library Service

6.4 "Librarianship Embraces Virtual Media Based on Adult Learning Theory"

 Azure

Teaching Methods SIG

Convener/Moderator: Jen Pecoskie, Wayne State University

Acquisition, creation, and delivery of high quality virtual media will be presented in this session with examples of virtual museums, exhibits, and library resources in immersive 3D learning environments based on adult learning theory.

Presenter: Valerie J. Hill, Texas Woman's University

6.5 "Questioning the Past: Finding, Presenting, and Using the Beautiful Answers of Historical Inquiry"

 Menzies Suite – Grand Hyatt Hotel

Historical Perspectives SIG

Conveners: Ellen Pozzi, William Paterson University, and C. Sean Burns, University of Missouri - Columbia

What do scholars consider when undertaking historical investigations? How can we use historical findings? How can historians bring the past to life through presentations? Three LIS historians explore these questions.

Presenters: Charles Seavey, Emporia State University; Jean L. Preer, Indiana University-Indianapolis; and Sharon McQueen, University of Wisconsin at Madison

3:00 p.m. - 3:30 p.m.

Afternoon Break

 Ballroom Foyer

3:30 p.m. - 4:30 p.m.

ALISE Business Meeting and Kick-off to 2014

 Ballroom A-C

The business meeting will include reports to the membership regarding budget information, association accomplishments, and plans for the future. During this meeting, the membership will be voting on the individual member dues increase proposal, the addition of a new professionals membership category, and the acceptance of the ALISE Diversity Statement. This meeting will end by kicking off the plans for 2013/14 President Abels' conference theme of "Educational Entrepreneurship."

4:30 p.m. - 6:00 p.m.

Special Session: "What of Diversity? (Always the Beautiful and Essential Question): An Ignite Session on Ideas You Can Use To Advance Diversity"

 Ballroom D -E

ALISE Diversity Statement Task Force & ALISE Multicultural, Ethnic, and Humanistic Concerns SIG

Moderator: Shari Lee, St. John's University

An introduction to the ALISE Diversity Statement and next steps, followed by an "ignite" DIY session on diversity action that can be readily implemented in the classroom, scholarship or institution.

Convener and Presenter: Clara M. Chu, University of North Carolina at Greensboro

Presenters: Renate Chancellor, Catholic University; Sam Hastings, University of South Carolina; Ricardo Punzalan, University of Maryland; Howard Rodriguez-Mori, Florida State University; Loriene Roy, University of Texas at Austin; and Mega Subramaniam, University of Maryland

6:30 p.m. - 8:00 p.m.

Awards Reception

 Seattle Public Library, 1000 4th Avenue, Seattle, WA 98104

(Hors d'oeuvres and cash bar)

Maps and walking directions are available at the ALISE registration Desk. If you are not able to walk to the library because of physical restrictions, please alert ALISE staff at the registration desk.

7:00 a.m. - 7:30 a.m.

All Conference Continental Breakfast Ballroom Foyer

7:30 a.m. - 8:30 a.m.

SIG Business Meetings: Session 3 Ballroom D-E

Join special interest groups for planning and information discussion

- Adjunct/Part-time Faculty: Catherine Closet-Crane, Kent State University
- Assistant/Associate Deans and Directors: Rae-Anne Montaque, University of Illinois at Urbana-Champaign
- Doctoral Students: Tammy Mays, University of Wisconsin at Madison, and Lenese Colson, Florida State University
- Historical Perspectives: Ellen Pozzi, William Patterson University, and C. Sean Burns, University of Missouri - Columbia
- Teaching Methods: Jen Pecoskie Wayne State University
- Youth Services: Sarah Park Dahlen, St. Catherine University, and Anna Nielsen, University of Illinois at Urbana-Champaign

8:30 a.m. - 10:00 a.m.

Session 7: Programs and Papers**7.1 OCLC/ALISE Grant Papers** Cobalt

Moderator: Lynn Silipigni Connaway, OCLC

"A New Unsupervised Approach to Automatic Topic Indexing of Scientific Documents According to Library Controlled Vocabularies"

Presenters: Abdhussain Mahdi and Arash Joorabchi, University of Limerick

"Reference Competencies from the Practitioner's Perspective: An International Comparison"

Presenters: Laura Saunders and Mary Wilkins Jordan, Simmons College

"The Biblioblogosphere: A Comparison of Communication and Preservation Perceptions and Practices between Blogging LIS Scholar-Practitioners and LIS Scholar-Researchers"

Presenters: Carolyn Hank, University of Tennessee, and Cassidy Sugimoto, Indiana University-Bloomington

7.2 Juried Papers: Meta-Perspectives in LIS Research Azure

Moderator: Heidi Julien, University of Alabama

"Research Agendas and Time: Persistence and Change in the Profession's Questions"

This paper explores in detail what has remained unchanged over time and what has altered with respect to stated research agendas for the field of

librarianship.

Presenters: John M. Budd and Denice E. Adkins, University of Missouri - Columbia

"Maximal (M3) Inquiry: Range of Theory Talk in Library Science Research"This paper reports on a study examining how theory is "talked about" in the library science literature. Findings resulted in an explanatory structure depicting a continuum of "theory talk" (from minimum to moderate to major; M³). This explanatory structure and guidance for implementing theory into the curriculum will be shared.

Presenters: Deborah Charbonneau, Kafi Kumasi, and Dian Walster, Wayne State University

"Conducting Young Children Randomized Control Studies within Public Library Settings: Research Barriers and Possibilities"

This paper vets issues related to conducting research involving young children within public library environments. A random control assignment study designed to determine the extent to which extended participation in library-based youth social settings, specifically the summer-reading program, impacts the reading achievement, activity, and attitudes of children provides a discussion platform.

Presenter: Janet Capps, The Ohio State University

7.3 "New Directions in Archival Education: Teaching Pluralized Curricula" Ballroom C

Convener and Presenter: Michelle Caswell, University of California - Los Angeles

In this panel, four new archival educators provide practical tips for pluralizing the archives curriculum based on their experiences creating community-based service learning projects, social justice-oriented case studies, exercises focused on non-textual formats, and outreach to undergraduates.

Presenters: Kimberly Anderson, University of Wisconsin at Milwaukee; Lorraine Dong, University of Texas at Austin; and Ricardo Punzalan, University of Maryland

7.4 "Development and Fundraising for IS Programs" Ballroom B

Development and Fundraising SIG

Convener and Panelist: Ed Cortez, University of Tennessee

Panelists will provide a forum for sharing ideas and solutions relating to development involving gift giving, fundraising, corporate partnerships, advisory board relationships, alumni affairs and marketing strategies. The interactive session will include audience participation around such topics as cultivating relationships with development officers and foundations, identifying and targeting donors, and developing philanthropic partners.

Panelists: Stephen T. Bajjal, Wayne State University; Beth Paskoff, Louisiana State University; Diana Stroud, University of Illinois at Urbana-Champaign; and Patrick Powell, University of Tennessee

7.5 Beautiful Connections: Questions in Distance Education

 Ballroom A

Distance Education SIG

Convener: Nora Bird, University of North Carolina at Greensboro

The session will explore new research by three presenters on the connection opportunities that extend beyond the virtual classroom. Presenters will explore walled gardens, communities of practice, and ego-centric analysis of connectedness.

Presenters: Michael Stephens, San Jose State University; Kyle Jones, University of Wisconsin at Madison; Jennifer Branch, Joanne de Groot, and Kandise Salerno, University of Alberta; and Fatih Oguz and Nancy Poole, University of North Carolina at Greensboro

10:00 a.m. - 10:30 a.m.

Morning Break

 Ballroom Foyer

10:30 a.m. - Noon

Special Session: "How Do You Know That They Know? Devising, Assessing, and Utilizing Program-level Student Learning Outcomes"

 Ballroom C

Moderator: Vicki Gregory, University of South Florida

Panelists will spark discussion on learning assessment systems: the objectives devised, data collection methodologies being employed, and the pedagogical strategies in use to address the results.

Presenters: Roy Bonin, Carleton University; Kristin Eschenfelder, University of Wisconsin at Madison; and Joseph Janes, University of Washington

Special Session: "Inclusive Gigabit Libraries: Learn, Discuss, and Brainstorm"

 Ballroom A

With IMLS support, this forum examines library futures and Internet access through next generation broadband connectivity. We'll focus on US Ignite efforts to build gigabit networks with practical, real-world applications.

Presenter: Jon Gant, University of Illinois at Urbana-Champaign

Noon - 3:00 p.m.

ALISE Board of Directors Meeting

 Azure

Noon - 2:00 p.m.

ProQuest Training Workshop

 Ballroom D-E By invitation only. Reservation required.

ProQuest's Graduate Education Program offers LIS educators and students free access to a wide variety of resources. Join us for an in-depth look at the content and tools available on the ProQuest academic platform.

Presenters: Karen Hinton and Kimberly Bastian, ProQuest

2014 Call for Proposals

OCLC and ALISE seek applicants for research grants. The OCLC/ALISE Library and Information Science Research Grant program awards up to \$15,000 to foster quality research by full-time faculty in schools of library and information science. Funded projects should be completed during 2014, and the findings published in the public domain. Application materials are available on the OCLC web site, at www.oclc.org/research/grants.html.

Submission deadline for the 2014 awards is September 15, 2013.

For more information contact

**OCLC Research
research@oclc.org**

2014 ALISE Annual Conference Educational Entrepreneurship

Tuesday, January 21 - Friday, January 24, 2014 Philadelphia, Pennsylvania

Every time you want to make any important decision, there are two possible courses of action. You can look at the array of choices that present themselves, pick the best available option and try to make it fit. Or, you can do what the true entrepreneur does: Figure out the best conceivable option and then make it available (Burgstone, 2012, p. 158)*

Educational entrepreneurship is sweeping across the academy. It is time for the information professions to embrace entrepreneurship and for LIS educators to incorporate it into our pedagogy and research. We need new ways of doing things, new partners, and new sources of funding. Join us at ALISE 2014 to explore the implications of educational entrepreneurship for LIS education.

The enormous change in higher education over the past few years is evident. Many universities are offering free online courses for thousands of students through Massive Open Online Course platforms (MOOC) such as Coursera and Udacity. EPIC 2020 (epic2020.org), an organization focused on higher education reform, predicts the end of tuition based educational institutions by 2020. These and other trends mean we can only imagine how higher education might evolve in the future.

You are invited to contribute your ideas and expertise on the conference theme of Educational Entrepreneurship at the ALISE 2014 Annual Conference and to participate in an exploration of educational entrepreneurship and its meanings and applications to postsecondary education and specifically LIS education.

Potential topics related to entrepreneurship could include but are not limited to:

- Program revision
- Curricular innovation
- Program delivery
- Innovative service learning initiatives
- High impact practices
- Novel pedagogical approaches
- Approaches to research

We are interested in learning about the opportunities and challenges of educational entrepreneurship in your institutions.

Opportunities for sharing include juried paper proposals, juried panel discussions, work in progress poster sessions, doctoral poster sessions, lightning talks, and SIG panels. Engage in discourse with colleagues at roundtable discussions, SIG meetings, the popular “birds of a feather” meeting, during breaks, and at various conference venues.

Please check the ALISE website (www.alise.org) periodically for more detailed calls for participation.

The Conference Planning Committee for 2014:

Coordinating Co-Chair: Howard Rosenbaum, Indiana University, hrosenba@indiana.edu

Coordinating Co-Chair: Linda Lillard, Clarion University, llillard@clarion.edu

Co-Chairs, ALISE Academy Committee: Trudi Hahn, Drexel University, tbh29@drexel.edu and Denise Agosto, Drexel University, dea22@drexel.edu

Co-Chairs, ALISE Jean Tague-Sutcliffe Doctoral Poster Competition Committee: Susan Davis, Drexel, sed48@drexel.edu and Athena Salaba, Kent State, asalaba@kent.edu

Chair, Works in Progress: Pnina Fichman, Indiana University, fichman@indiana.edu

Doctoral SIG Conveners: TBD

Co-Chairs, Council of Deans, Directors and Program Chairs: TBD

Chair, Conference Juried Paper Proposals Committee: Linda C. Smith, University of Illinois at Urbana-Champaign, lcsmith@illinois.edu

Chair, Conference Panel Proposal Committee: Claudia Gollop, University of North Carolina at Chapel Hill, gollop@email.unc.edu

Director for Special Interest Groups: Don Latham, Florida State University, dlatham@fsu.edu

Board Liaison: Eileen Abels, Drexel University, ega26@drexel.edu

*Burgstone, J., & Murphy, B. Jr. (2012). Breakthrough entrepreneurship. San Francisco, CA: Farallon Publishing.

ALISE 2014
Annual Conference
See you Next Year!



ALISE'14 Annual Conference
January 21-24, 2014
Philadelphia, PA
www.alise.org

2014 ALISE Annual Conference Educational Entrepreneurship

Tuesday, January 21 - Friday, January 24, 2014 Philadelphia, Pennsylvania

Call for Juried Paper Proposals

Deadline for paper proposal submissions (maximum 1,000 words): July 15, 2013

Notification of acceptance: September 15, 2013

This call for juried paper proposals seeks original contributions including reports of research, theory, pedagogy, best practices, think pieces, and critical essays that contribute to elaboration of the conference theme of “Educational Entrepreneurship.” Potential topics related to entrepreneurship could include but are not limited to: Program revision; Curricular innovation; Program delivery; Innovative service learning initiatives; High impact practices; Novel pedagogical approaches; Approaches to research.

Submissions should be original papers that have not been previously published. There are no restrictions on research methodology. Alternative perspectives on educational entrepreneurship in library and information science are welcomed and encouraged.

Instructions for Submission

Submissions will include the following:

- Title of the paper
- Names, affiliations, and contact information of the authors, with one author designated as the contact for the paper
- 50-word abstract for the conference program
- Up to 1,000 word extended abstract with a select reference list (.doc or .docx file)

Abstracts will be evaluated by the Juried Paper Proposal Committee according to the following criteria:

- Connection to conference theme
- Relevance to current and emerging issues in LIS education
- Originality of ideas
- Potential impact/significance
- Select references to relevant literature
- Overall quality of writing

Submissions will be made through the Easy Chair system, at www.easychair.org/conferences/?conf=alise2014

Follow these steps:

1. Log on the system (create an EasyChair account if you do not already have one)
2. If you are also a reviewer, please be sure to select “author” as your role for your own submission.
3. Select “New Submission”.
4. Complete all the information requested. Enter a title and provide a 50-word abstract for your submission. This will be used for the Conference Program.
5. Upload your file (extended abstract) and press “Submit”.
6. You should also receive a confirmation email from the EasyChair system.

Please note: submitting a proposal constitutes your permission for ALISE to publish the brief and extended abstracts in the conference program and on the ALISE website, if your proposal is accepted.

Deadline for submissions is July 15, 2013.

Applicants will be informed of the Committee’s decisions by September 15, 2013. Conference presentation time slots will be published in the conference program. All presenters are required to register for the ALISE 2014 conference.

Please note: Juried paper proposals accepted for presentation at the conference, which are developed into full papers, are eligible for consideration for the *Journal of Education for Library and Information Science (JELIS)* “best papers” conference issue. Deadline for submission of full papers for possible publication in *JELIS* will be March 1, 2014, and those submissions should be made to the editors of *JELIS*.

Linda C. Smith

Professor and Associate Dean for Academic Programs
Graduate School of Library and Information Science
University of Illinois at Urbana-Champaign
501 E. Daniel St.
Champaign, IL 61820
lcsmith@illinois.edu
217-333-7742

ALISE Awards, Honors, and Grants for 2014

Be part of the ALISE Awards, Honors, and Grants program for 2014! There are many opportunities to nominate a colleague or to apply for an award.

ALISE Awards

Deadline for all awards in this category: July 15, 2013

ALISE Service Award

For outstanding service to ALISE

Chair: Kathryn Plunkett, Southeastern Oklahoma State (kplunkett@se.edu)

ALISE Award for Professional Contribution

For leadership in library and information science education

Chair: C. Sean Burns, University of Missouri-Columbia (csbc74@mail.mizzou.edu)

ALISE Award for Teaching Excellence

For excellence in teaching library and information science

Chair: Juliet Drennan, Simmons College (juliet.drennan@gmail.com)

ALISE/Pratt-Severn Faculty Innovation Award

For innovation in incorporating evolving information technologies in library and information science curricula

Chair: Robin Kurz, University of South Carolina (robinfoglekurz@gmail.com)

ALISE/Norman Horrocks Leadership Award

For outstanding leadership demonstrated in ALISE activities during the first few (up to seven) years as a member

Chair: Valerie Hill, Texas Woman's University (villedu@gmail.com)

ALISE Annual Conference Awards

Variable deadlines, beginning July 15, 2012; see below for specifics

ALISE/University of Washington Information School Youth Services Graduate Student Travel Award

A stipend of \$750 to support the attendance of a member of the Youth Services SIG who is actively participating in the ALISE conference

Deadline: November 1, 2013

Chair: TBD

Doctoral Students to ALISE Grant

A stipend of \$500 to support the attendance of one or more promising LIS doctoral students at the ALISE Annual Conference; selected by members of the ALISE Board

Deadline for nominations from institutional member schools: September 20, 2013

ALISE/Jean Tague - Sutcliffe Doctoral Student Research Poster Competition

For the outstanding poster in the ALISE Doctoral Student Research Poster Competition reporting on dissertation research

Deadline for abstracts to participate in the poster session: October 1, 2013

Chair: Susan David, Drexel University (sed48@drexel.edu) and Atehna Salaba, Kent State University (asalaba@kent.edu)

ALISE Research Competitions

Variable deadlines, beginning June 30, 2012; see below for specifics

ALISE Research Grant Competition

An award of one or more grants totaling \$5,000 to support research broadly related to education for library and information science.

Deadline: October 1, 2013

Chair: Gary Burnett, Florida State University (gburnett@fsu.edu)

OCLC/ALISE Library and Information Science Research Grant Program

Grants of up to \$15,000 to foster research by faculty in schools of library and information science; proposals from junior faculty are especially encouraged.

Deadline: September 15, 2013

Chair: Lynn Silipigni Connaway, OCLC (connawal@oclc.org)

ALISE/Bohdan S. Wynar Research Paper Competition

For an outstanding unpublished research paper concerning any aspect of library and information science.

Deadline: July 15, 2013

Chair: Ying-Hsang Liu, Charles Sturt University (yingliu@csu.edu.au)

ALISE/ProQuest Methodology Paper Competition

An award of \$500 for an outstanding unpublished paper explaining a particular research method or technique and the methodological implications for library and information science.

Deadline: July 15, 2013

Chair: Lynne McKechnie, Western University (emckech1@uwo.ca)

ALISE/Eugene Garfield Doctoral Dissertation Competition

An award of \$500 for an outstanding library and information science dissertation completed between December 15, 2011 and June 30, 2013.

Deadline: June 30, 2013

Chair: Soo Young Rieh, University of Michigan (rieh@umich.edu)

ALISE/LMC Paper Award

An award of \$1000 to recognize an outstanding unpublished paper reporting innovative research in youth services.

Deadline: July 15, 2013

Co-chairs: TBD

Opportunities are summarized on this sheet. Find more details at ALISE.org

2013 AWARD WINNERS

ALISE Awards

ALISE Award for Professional Contribution to Library and Information Science Education

- Ann Prentice, University of Maryland

ALISE Award for Teaching Excellence in the field of Library and Information Science Education

- Deborah Barreau, University of North Carolina

ALISE Service Award

- Lorna Peterson, University at Buffalo, State University of New York

ALISE/Pratt-Severn Faculty Innovation Award

Sponsored by Pratt Institute

- Anthony Cocciolo, Pratt Institute

ALISE/Norman Horrocks Leadership Award

- Nicole Cooke, University of Illinois at Urbana/Champaign

ALISE Research Awards/Grants

ALISE/Bohdan S. Wynar Research Paper Competition

- Marie Radford, Rutgers University, and Lynn S. Connaway, OCLC
- Joseph Tennis, University of Washington

ALISE Research Grant

- Karen Gavigan and Kendra Albright, University of South Carolina

ALISE/Eugene Garfield Doctoral Dissertation Competition

- Kimberly Anderson, University of California - Los Angeles
- Michelle Caswell, University of Wisconsin at Madison

ALISE/ProQuest Methodology Paper Competition

- Beth St. Jean, University of Maryland

ALISE/LMC Paper Award

Sponsored by Libraries Unlimited/Linworth, imprint of ABC-CLIO

- Jeffrey DiScala and Ann Carlson Weeks, University of Maryland

ALISE 2012 Best Conference Paper Award

- Michelle Louise Atkin, Algoma University
- Susan E. Searing, University of Illinois at Urbana/Champaign
- Kim M. Thompson, Charles Sturt University; and Denice Adkins, University of Missouri - Columbia

OCLC/ALISE Library and Information Science Research Grant Competition

- To be announced at Annual Conference

ALISE Annual Conference Awards/Grants

ALISE/Jean Tague - Sutcliffe Doctoral Student Research Poster Competition

Sponsored by Western University

- Winner selected at Annual Conference

ALISE/University of Washington Information School Youth Services Graduate Student Travel Award

- Karla Lucht, University of Illinois at Urbana/Champaign

Doctoral Students to ALISE Grant

Sponsored by Libraries Unlimited/Linworth, imprint of ABC-CLIO

- Nancy Poole, University of North Carolina at Greensboro

Doctoral Student to ALISE Grant

Sponsored by John Bertot, University of Maryland

- Maria Otero-Boisvert, San Jose State University
- Jeffrey DiScala, University of Maryland

THANKS TO OUR SPONSORS AND EXHIBITORS

President's Circle (\$2,500+)

- Libraries Unlimited/Linworth, imprint of ABC-CLIO
- H. W. Wilson Foundation
- OCLC
- Seattle Public Library
- University of Washington

ALISE Partner (\$1,500+)

- Florida State University

ALISE Associate (\$1,000+)

- Bound to Stay Bound
- Dominican University
- Freedom to Read Foundation
- University of Alabama

Exhibitors

- Alabama, University of
- ALA Neil-Schuman
- Canadian Journal of Information Library Science (Friends' Table)
- Libraries Unlimited/Linworth, imprint of ABC-CLIO
- OCLC
- ProQuest
- Rutgers University
- San Jose State University
- Scarecrow Press
- South Carolina, University of
- University of Chicago Press (Friends Table)
- Young Adult Library Services Association (YALSA)

Doctoral Student Reception Sponsoring Schools (as of December 18, 2012)

- Dominican University
- Drexel University
- Florida State University
- Illinois at Urbana-Champaign, University of
- Louisiana State University
- Missouri at Columbia, University of
- Pittsburgh, University of
- Rutgers University
- San Jose State University
- South Carolina, University of
- Tennessee, University of
- Texas at Austin, University of
- Wisconsin-Madison, University of
- Wisconsin-Milwaukee, University of

RAFFLES

ALISE will be hosting a raffle this year to support the ALISE Endowment Fund. Buy your raffle tickets at the ALISE registration desk located in the Ballroom Foyer of the Hyatt at Olive 8 Hotel.

2014 Conference Raffle

Prize

A five-night stay at the Double Tree by Hilton Philadelphia City Center Hotel. This hotel stay is to be used for the 2014 ALISE Annual Conference in Philadelphia. Estimated cost of this prize is \$1000. Raffle tickets will be sold for \$15 or 2 tickets for \$25.

Libraries Unlimited/Linworth, imprint of ABC-CLIO Raffle

Prize

Win the entire collection of approximately 105 books displayed by Libraries Unlimited/Linworth Publishing. This fabulous collection has a retail value of over \$4500! It includes titles for faculty, librarians, media specialists, and LIS students and will add significant resources to your library!

This prize is generously donated by Libraries Unlimited/Linworth, imprint of ABC-CLIO. Raffle tickets will be sold for \$15 or 2 tickets for \$25.

ALISE GOVERNANCE

Resolutions

Written copies of all resolutions, including resolutions contained in committee reports, must be given to the membership before they are to be presented to that body for action. To permit this, text must be submitted to the Governance Committee 24 hours in advance of presentation. A resolution that has fiscal implications must be submitted to the President as well as the Governance Committee 24 hours before it is to be voted on so that the Budget Committee can provide information on fiscal implications.

Resolution approved January 13, 1979, limits resolutions to statements on substantive matters relating to library education and the profession of librarianship to be voted on by membership.

Governance Committee

Lynne Howarth, University of Toronto (chair)
Lorna Peterson, University at Buffalo
Linda C. Smith, University of Illinois
Connie Van Fleet, University of Oklahoma

Our Vision:

By 2014, ALISE will be known as the international leader in Library and Information Science education with strong links to schools and faculty around the world. We will also engage with other organizations and scholars in cognate disciplines. ALISE will showcase innovative research, including the scholarship of teaching and learning, promote greater diversity and inclusion as a hallmark of membership, and build and communicate its strength through greater visibility and voice.

Our Mission:

ALISE promotes innovation and excellence in research, teaching, and service for educators and scholars in Library and Information Science and cognate disciplines internationally through leadership, collaboration, advocacy, and dissemination of research.

Our Strategic Directions:

Areas for Strategic Development

Strategic Direction 1: consolidating and expanding the membership base by positioning the Association as an organization of members

Strategic Direction 2: enhancing collaboration and extending ALISE membership to scholars in cognate disciplines and affiliated organizations, nationally and internationally

Core Strategic Areas (ongoing)

Strategic Direction 3: focusing on the scholarship of teaching and learning and the promotion of outstanding research

Strategic Direction 4: providing sound fiscal management, fostering administrative best practice, and advancing effective communication strategies for ALISE and its members



The Library Quarterly

ALISE Annual Conference Discount ♦ Individuals Save 30%

“As the oldest scholarly journal of library research in the United States, *Library Quarterly* has a venerable and impressive history of documenting research about libraries from a wide variety of perspectives. Perhaps the greatest strength of the journal is its dedicated focus on library research, particularly in an age when a great many journals formerly focused on library research have folded or repositioned themselves to publish research about information (e.g., management, processing, retrieval, technology)—which can include, but is often focused beyond, libraries.” (From Bertot et al., “*Library Quarterly* in the Twenty-First Century, Part 1,” *Library Quarterly* Vol. 82 No. 4, October 2012.)

The Library Quarterly is an international journal dedicated to scholarship about libraries as organizations that connect their communities to information. *LQ* embraces a wide array of original research perspectives, approaches, and types of analysis, making it the journal best positioned to chronicle the evolution of libraries and the related intersections of information, community, and policy.

Use code 2013LQ30 ♦ Offer expires February 28, 2013



CHICAGO JOURNALS
www.journals.uchicago.edu

MAP: HYATT AT OLIVE 8

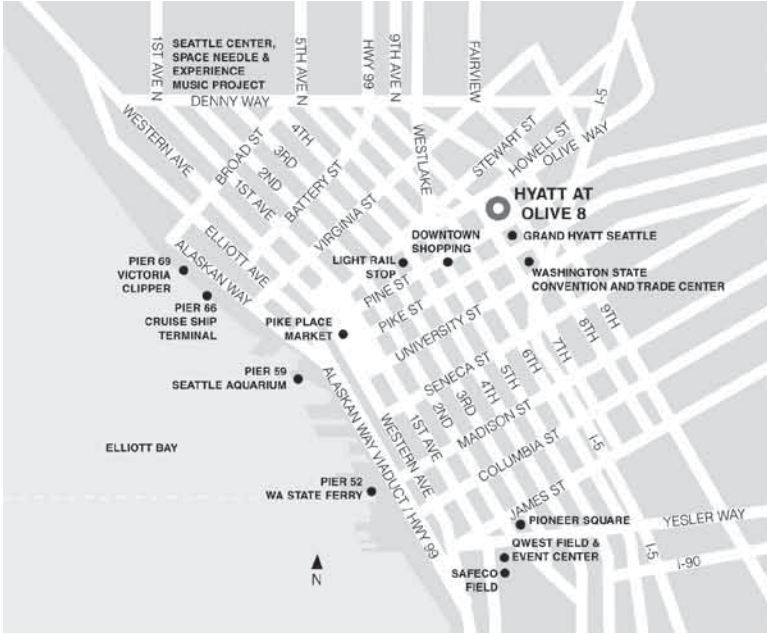

Hyatt at Olive 8

DIRECTIONS

From Sea-Tac Airport: Follow signs I-5 Northbound. Continue on I-5 North for 14 miles. Exit from the left lane at Seneca Street. Right on Sixth Avenue. Right on Pike Street. Left on Eighth Avenue. Continue forward through Pine Street. The Hyatt at Olive 8 entrance is the second driveway on the left.

From I-5 North Bound: Exit from the left lane at Seneca Street. Right on Sixth Avenue. Right on Pike Street. Left on Eighth Avenue. Continue forward through Pine Street. The Hyatt at Olive 8 entrance is the second driveway on the left.

From I-5 South Bound: Take the Union Street Exit. Continue forward onto Union Street. Turn right on Seventh Avenue. Right on Pike Street. Left on Eighth Avenue. Continue forward through Pine Street. The Hyatt at Olive 8 entrance is the second driveway on the left.

From I-90 West Bound: Merge onto I-5 North via Exit #2c toward Madison Street / Convention Center / Vancouver, BC. Take Madison Street / Convention Center exit. Follow exit forward onto Seventh Avenue. Right on Madison Street. Left on Eighth Avenue. Continue forward through Pine Street. The Hyatt at Olive 8 entrance is the second driveway on the left.

THIRD FLOOR

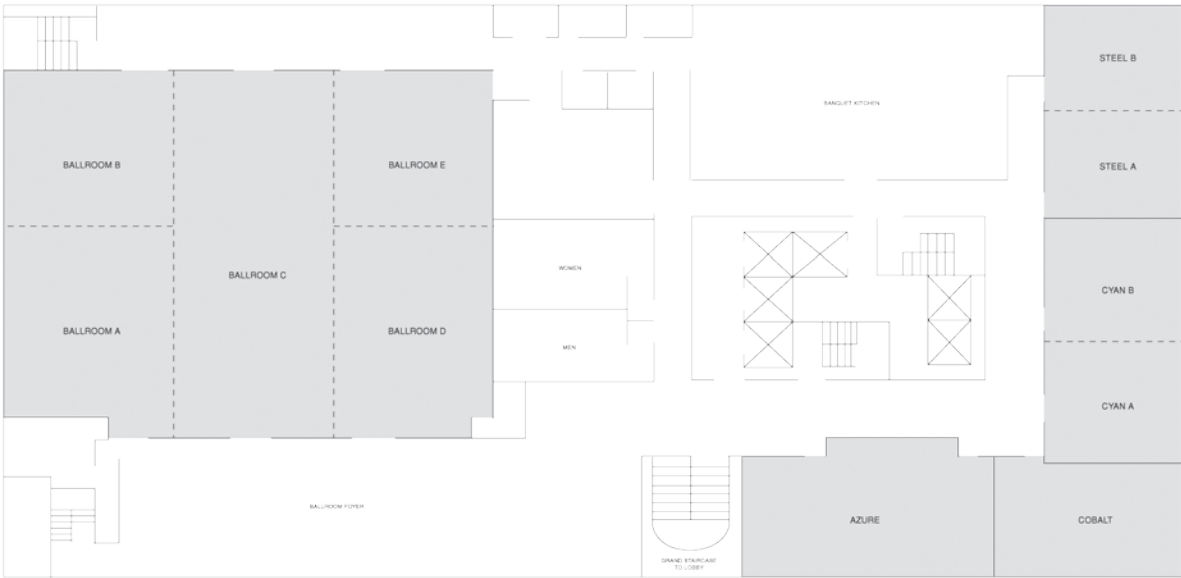

MAP: GRAND HYATT SEATTLE

FIRST FLOOR

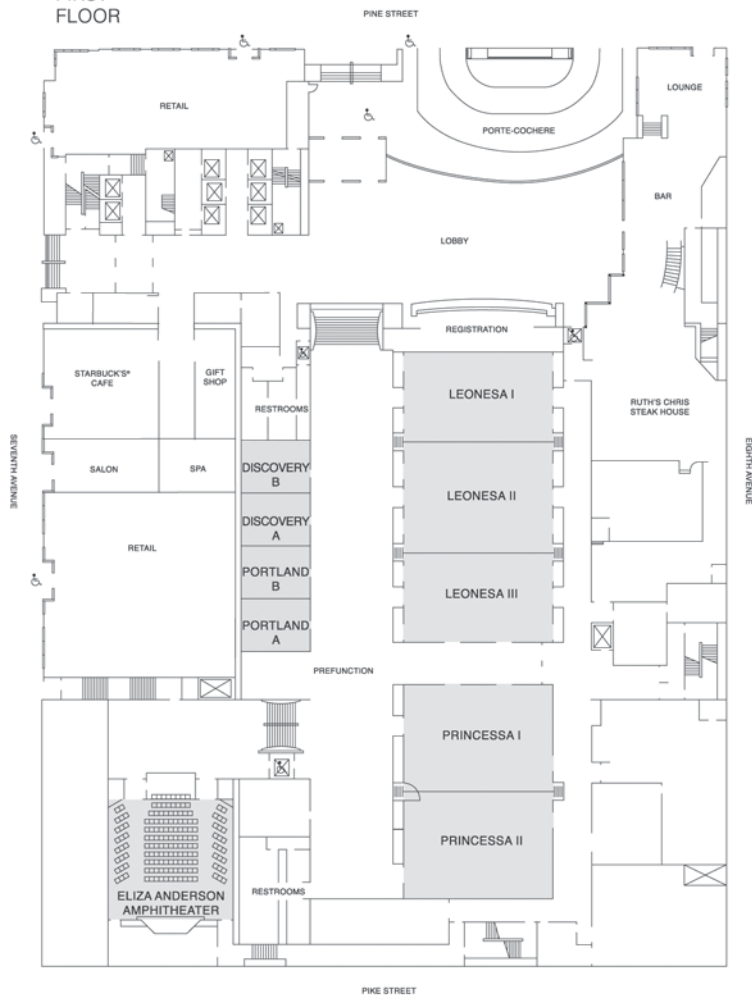

SIXTH FLOOR

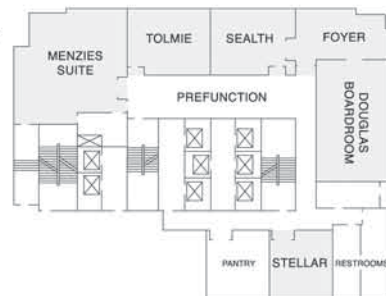

SEVENTH FLOOR

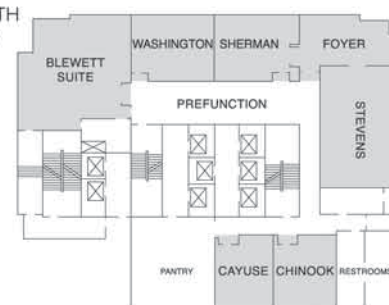

THEATER-BALLROOM LEVEL

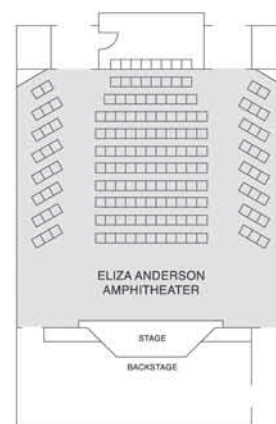



COLLEGE OF
INFORMATION
STUDIES

imagine

YOUR FUTURE WITH A DEGREE

FROM MARYLAND'S iSCHOOL!

Academic programs at the University of Maryland's College of Information Studies, Maryland's iSchool, prepare students for information careers in a diverse, dynamic setting just minutes from Washington, DC, the information capital of the world.

Degree programs:

- Master of Library Science (MLS)*
- Master of Information Management (MIM)*
- Master of Human-Computer Interaction (HCIM)
- PhD in Information Studies

* also available online and at the Universities at Shady Grove in Rockville, MD

ischool.umd.edu

M.S.L.I.S. — Perfect For You! *School of Library and Information Science*



Earn your master's degree in library and information science from Catholic University, with specializations in law, cultural heritage, digital libraries, school library media, information architecture, and others.

- CUA law librarianship program ranked #2 by *U.S. News & World Report*
- Evening, weekend, and hybrid online courses
- Scholarship opportunities available

**Now Accepting Applications for
Summer and Fall 2013.**

Visit Us at SLIS.CUA.EDU or Call 202-319-6138.

THE CATHOLIC UNIVERSITY OF AMERICA

The Catholic University of America admits students of any race, color, national or ethnic origin, sex, age, or disability.



Connecting people with information through technology at The iSchool at Drexel University

The iSchool, College of Information Science and Technology's faculty, students and graduates empower society by uniting people, technology and knowledge through cutting-edge research and education. As a leader in the field of information science and technology, the iSchool distinguishes itself through intellectual range of its programs and through the innovative research of its faculty in such areas as bibliometrics, information access and use, collaborative learning, digital libraries, human-computer interaction, social and healthcare informatics, artificial intelligence, and knowledge management, among others. The iSchool offers a PhD program in Information Studies and Master of Science programs in Library and Information Science, Information Systems, Health Informatics and Software Engineering, as well as opportunities for professional development.



Eileen Abels, Ph.D., 2013/14 ALISE President

and Associate Dean for Academic Affairs, Professor at The iSchool, College of Information Science and Technology at Drexel University, looks forward to working with members in the coming year.

3141 Chestnut Street, Philadelphia, PA 19104

215.895.2474 • ischool.drexel.edu



DREXEL UNIVERSITY

The iSchool

College of Information Science
and Technology